

PF Male Head Plug (JIS 30° Convex)

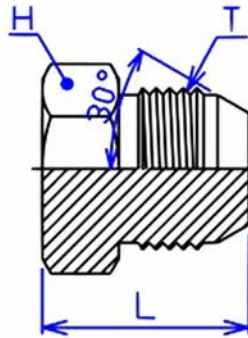

Soft Steel Mark : NBD

Item No	Description	Thread		Dimension (mm)				
		T (PF)	T1	L	L1	L2	L3	H
I02	1/4	1/4-19		23				14
I04	3/8	3/8-19		24.5				17
I05	1/2	1/2-14		28.5				21
I07	3/4	3/4-14		30.5				27
I08	1	1-11		33.5				33.3
I09	1 1/4	1 1/4-11		39				41
I0A	1 1/2	1 1/2-11		41				50
I0D	2	2-11		47				65